

# PICH NIL GRAPE FARM PROJECT

---

1,407 HECTARS



**SITE PROPOSED**

# PICH NIL GRAPE FARM PROJECT

1,407 HECTARS

Experience the Art of Grape Farming at Pich Nil

Suggest the land to investigate the appropriate region. Growing grapes at Pich Nil involves a sophisticated combination of creativity and scientific expertise; a profound understanding of environmental factors, including sunlight exposure, soil quality, and climate adaptability, ensures the grapes mature perfectly, showcasing the unique terroir of Pich Nil.



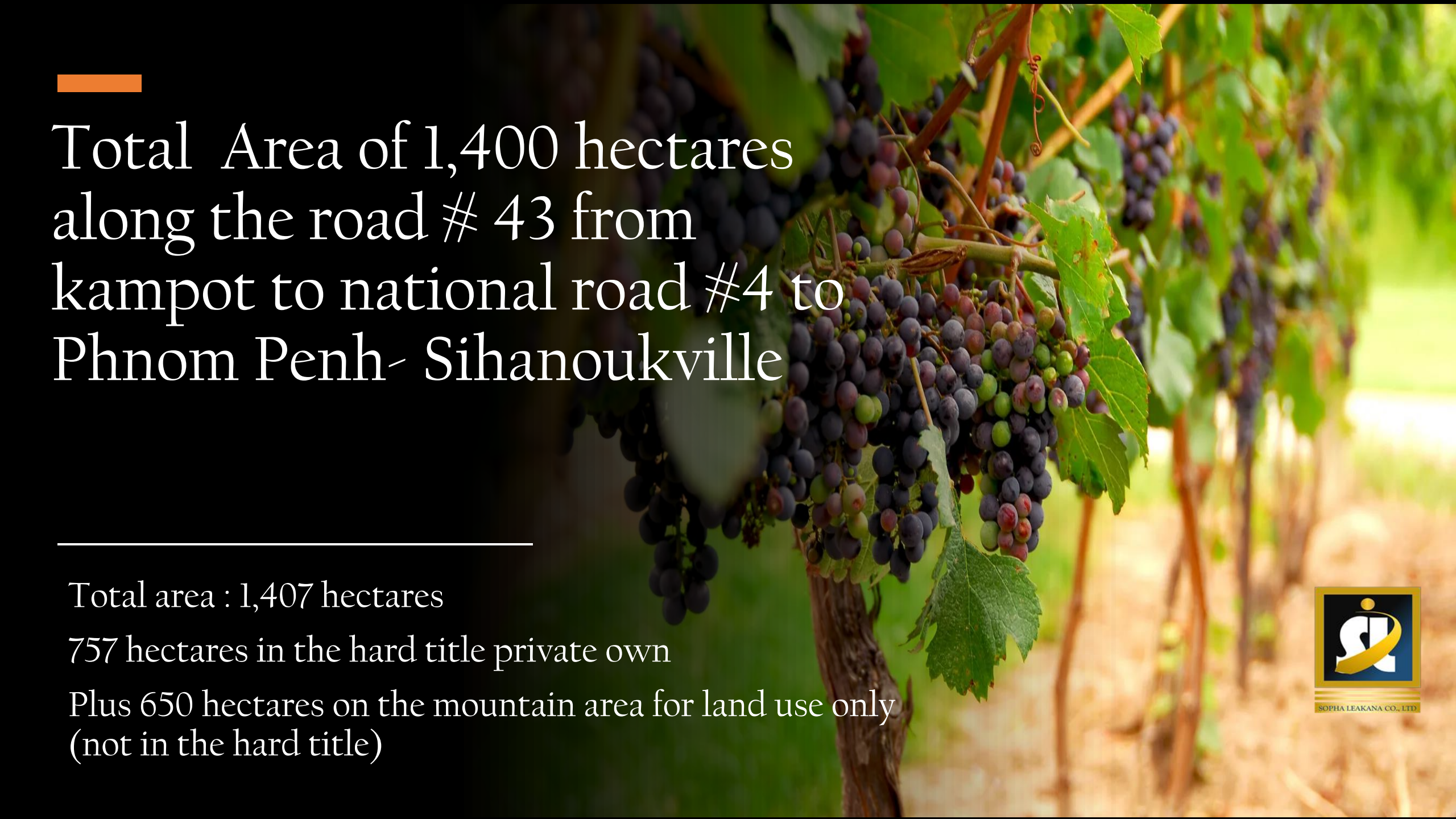

Total Area of 1,400 hectares  
along the road # 43 from  
Kampot to national road #4 to  
Phnom Penh- Sihanoukville

---

Total area : 1,407 hectares

757 hectares in the hard title private own

Plus 650 hectares on the mountain area for land use only  
(not in the hard title)





# AREA Background

The trip to the site is just as pleasurable as the destination. The rolling hill route twists through the center of the farming area, meandering past countless fields of durians, mangos, jackfruits, and more, while enjoying the crisp mountain breeze, enveloped by the province's renowned fruit groves. As you near the location, the temperature drops and the greenery grows denser. The Pich Nil is named for its gem region and other mineral. Although they are secure for habitation or agriculture, it is a piece of heaven in the area just moments from urban life.

---



# 1,400 HECTARS MAP SITE

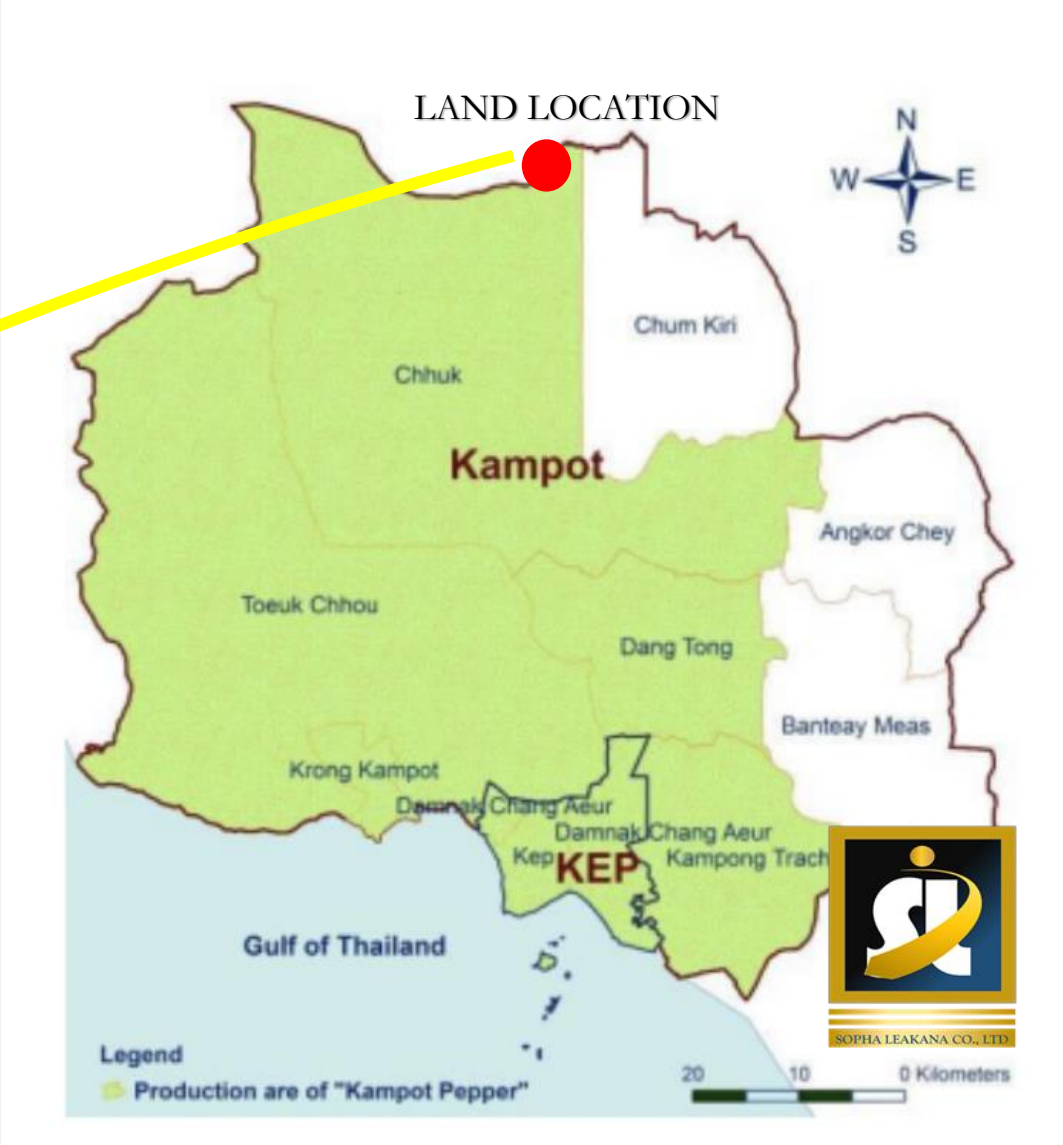

# Land location

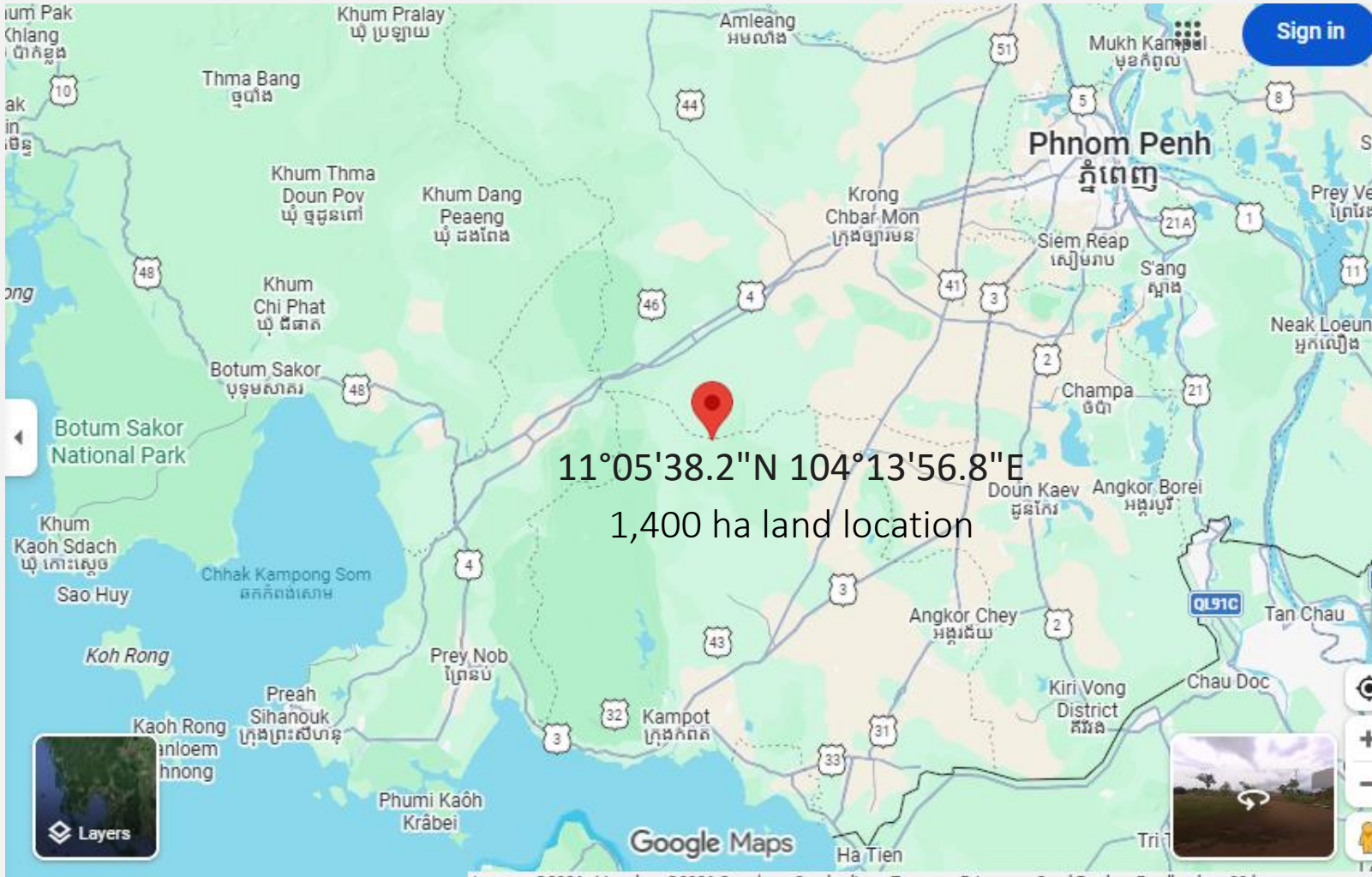

Total Area of 1,407 hectares along the road # 43 from kampot to national road #4 to Phnom Penh-Sihanoukville



# Land location

1,407 hectares

- Land size in title 757 hectare
- Plus 650 hectare on mounting area ( owner have the right to use).
- Address:
  - Commune Chey Sena Khom
  - Taken district Chhouk
  - Kampot Province Cambodia

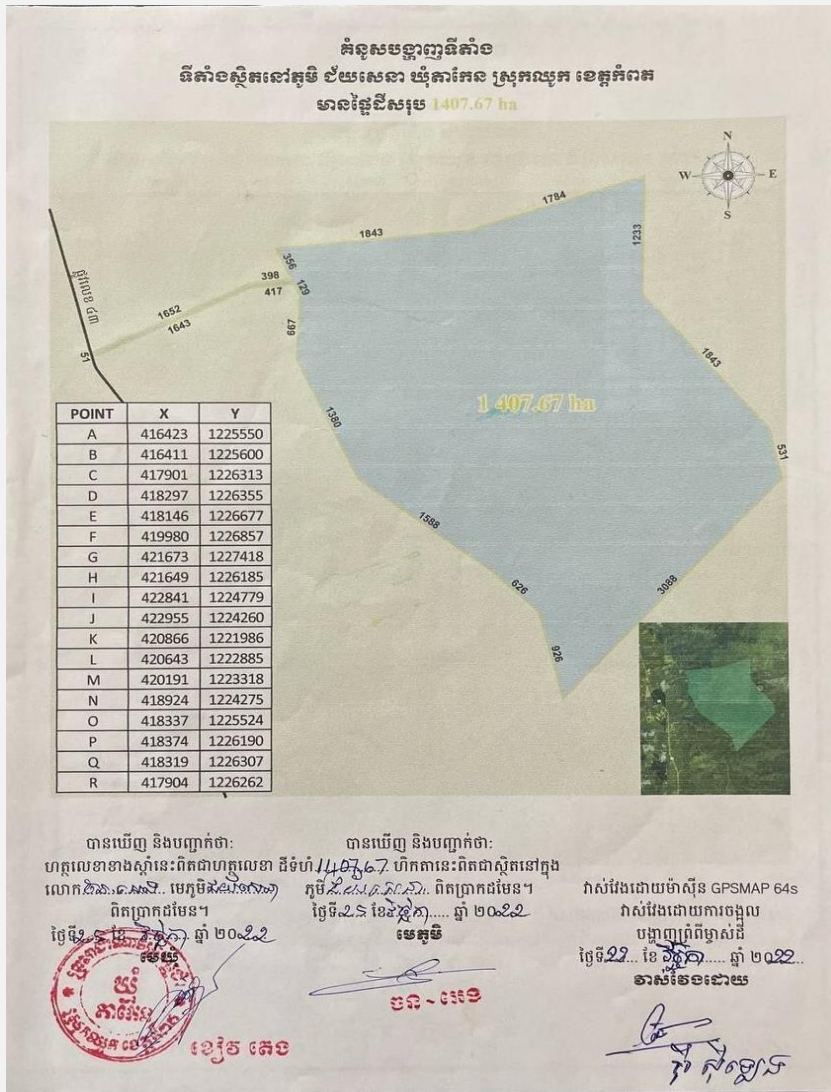

# LAND PRICE

---

Total Area:	1,407 Hectare
Price per Square Meter:	\$7.00
Cost Per hectare:	\$70,000.
Cost Per 757 hectare	\$52,990,000.
Land use 650 hectare on the mountain area at no cost (free)	





Land Condition  
1,407.Hectare





EXISTING  
DEVELOPMENT



SOPHA LEAKANA CO., LTD.



CONTACT PERSON:

DY SOPHA

CONTACT NUMBER:

855-92 136 265

THANK YOU

